

Magnolia Dredge & Dock, LLC

1730 Orleans Street, Mandeville, LA 70448

Phone: 985-778-0404

Site Contact – John Falcon

johnf@magnoliadredge.com

Phone- 985-320-0452

September 25, 2018

NOTICE TO MARINERS

Dear Sir or Madam:

Magnolia Dredge & Dock, LLC will be performing a Hydraulic Dredging project in the New Orleans Municipal Yacht Harbor. Dredge Equipment will be in the area along with a floating Pipeline and submerged Pipeline. The Northwest upper Portion of the Dredge area is located at approximately 30°01'41.434"N and 90°06'56.998"W the North east outer portion of the Cut is located at approximately 30°01'40.901"N and 90°06'52.405"W. The South West Outer Corner of the cut is at approx. 30°01'39.554"N and 90°06'57.013"W. The South East Corner of the Dredge cut is a approx. 30°01'39.655"N and 90°06'49.017"W. The Dredge **Moray** will be excavating material in this area and transporting it via 8" Black floating and submerged Hdpe Pipeline that will be marked every 60' with a orange floating buoy along with a floating marker buoy equipped with a amber flashing light where the pipe can float. Where the pipe is submerged the area will be marked with a buoy marked by 2 red lights one 3ft below the other on either side of the submerged weighted pipeline crossing located 100 feet to either side

of the line connecting between 30°01'42.874"N and 90°06'53.171"W and 30°01'40.901"N and 90°06'52.405"W . The Dredge and its Tenders will monitor Channel 13 and Channel 8 will be the working channel for the project. **The New Orleans Municipal Yacht Harbor has also established Channel 65A for boat traffic entering or requiring passage through the dredging zone.**

Magnolia Dredge & Dock, LLC would like to formally request that all Mariners avoid these areas if at all possible to insure their safety on the water and not to disrupt the Dredging and efforts. The Effective Start Date for the Project will be Monday October 1st, 2018 and is expected to last approx. 90 days. Our Crew will be moving equipment into the area leading up to the effective start date. Dredging operations will be conducted 12hrs a day, Seven days a week. We anticipate starting operations at 6:30 a.m. each day, pending weather.

Regards,

John Falcon

Project Manger

Magnolia Dredge & Dock, LLC

985-320-0452

985-778-0404

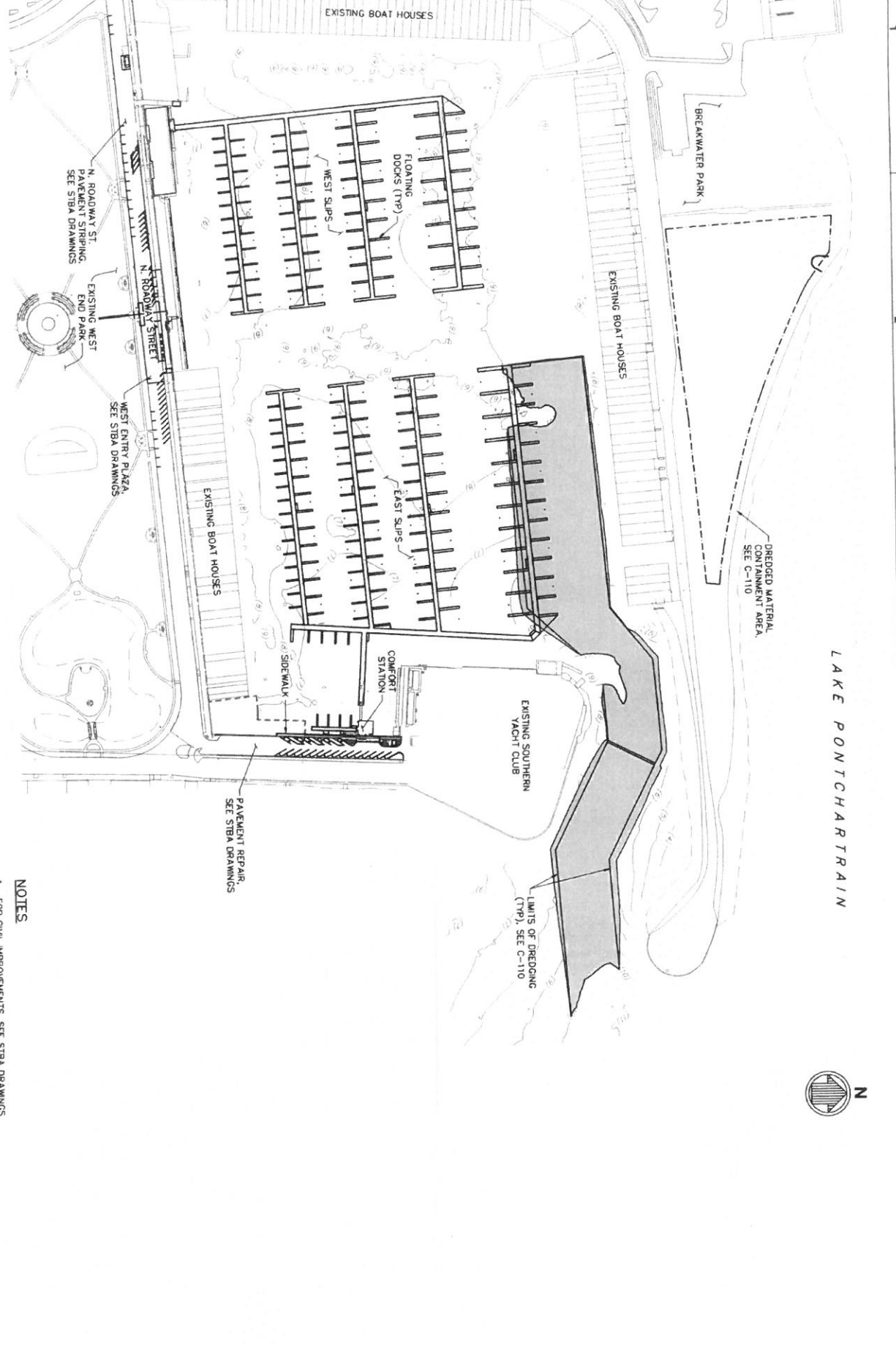

- NOTES**
1. FOR CIVIL IMPROVEMENTS, SEE SIBA DRAWINGS.
 2. FOR DREDGING AND MATERIAL CONTAINMENT, SEE SHEET C-110.
 3. FOR STRUCTURAL PLANS, SEE STRUCTURAL KEY PLAN SHEET S-100.



BID DRAWINGS
ISSUED: 2017-05-12
 NOT TO BE USED FOR CONSTRUCTION

DRAWING SCALES SHOWN BASED ON 22"x34" DRAWING

 PAN AMERICAN LIFE CENTER 601 PICHORAS ST., STE. 1060 NEW ORLEANS, LA 70130	Designed by JAM/AMP Date: 05.12.17	NEW ORLEANS MUNICIPAL YACHT HARBOR NEW ORLEANS, LA	<table border="1"> <thead> <tr> <th>Start</th> <th>Description</th> <th>Date</th> <th>Appr.</th> </tr> </thead> <tbody> <tr><td> </td><td> </td><td> </td><td> </td></tr> <tr><td> </td><td> </td><td> </td><td> </td></tr> <tr><td> </td><td> </td><td> </td><td> </td></tr> <tr><td> </td><td> </td><td> </td><td> </td></tr> <tr><td> </td><td> </td><td> </td><td> </td></tr> <tr><td> </td><td> </td><td> </td><td> </td></tr> <tr><td> </td><td> </td><td> </td><td> </td></tr> <tr><td> </td><td> </td><td> </td><td> </td></tr> <tr><td> </td><td> </td><td> </td><td> </td></tr> </tbody> </table>	Start	Description	Date	Appr.																																				
	Start			Description	Date	Appr.																																					
Drawn by SNE Checked by ARS	Date: 05.12.17 MEN Project No: 9523-00	OVERALL CIVIL SITE PLAN																																									
Reviewed by DIM	Drawing scale: Drawing Scale: Plot scale: 1:1 (0 SHEET)																																										
Submitted by CHRIS WILLIAMS MOFFATT & NICHOL	Reference No. C-100 Sheet 26 OF 191																																										